

## Stainless steel air vent

AlSi316 mirror-polished precision-cast stainless steel.

Code	B mm	Version	Centre distance A mm	Bore Ø mm
53.301.80	97x97	With screws	64	75
53.301.81	97x97	with studs	64	75
53.301.82	129x129	With screws	92	100
53.301.83	129x129	with studs	92	100

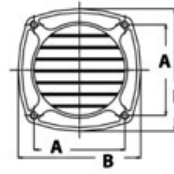

## ABS Hose vent with collar

Made of ABS plastic.

Code	mm					Type	Colour	For hose of items
	A	B	C	Ø Neck D	H			
53.273.01	92	92	62	76	-	straight	white	16.104.35
53.273.02	92	92	62	76	-	straight	Black	16.104.35
53.273.03	126	126	76	102	-	straight	white	16.104.36
53.273.04	126	126	76	102	-	straight	Black	16.104.36
53.274.01	92	92	108	76	32	90°	white	16.104.35
53.274.02	92	92	108	76	32	90°	Black	16.104.35

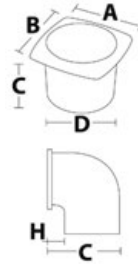

## Pivoting hose-vent connectors for stainless steel vents

Made of plastic.

Code	Reference vent	Type	Neck Ø mm	Tube Ø mm	Adaptable hose
53.404.01	53.301.80; 53.301.81; 53.302.01	90°	76	80	16.104.35
53.404.02	53.301.82; 53.301.83; 53.302.02	90°	102	102	16.104.36
53.404.03	53.301.80; 53.301.81; 53.302.01	straight	-	80	16.104.35

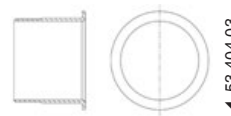
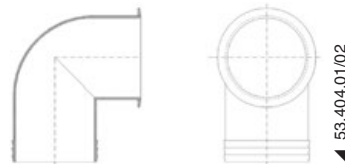

## Circular aerator

Made of polished stainless steel, fitted with rotating locking system.

Code	Fly screen	Ø mm
53.214.45	No	102
53.214.46	Yes	102
53.214.55	No	127
53.214.56	Yes	127
53.214.65	No	152
53.214.66	Yes	152



## Inlet/outlet air grid

Made of stainless steel, fitted with screen.

Code	Neck Ø mm
53.301.74	58



## Large capacity Louvred vents

Fitted with adjustable and closing white ABS fins, covering ring for the screws.

Code	External Ø mm	Version	Bore Ø mm
53.301.75	163	rear flush mount	115

